



LATAB
Industrial LED Lighting

Ring lights with 50° light beam angle

These ring lights are highly homogenous and characterized by a 50 degree inward aligned light output which places them between conventional ring lights and dark field lights.

This kind of illumination is used for example for shadow-free lighting of the inside of cylindrical objects.

Bracket is included (no. SXX3 010213, for details see bracket options).



Mechanical dimensions

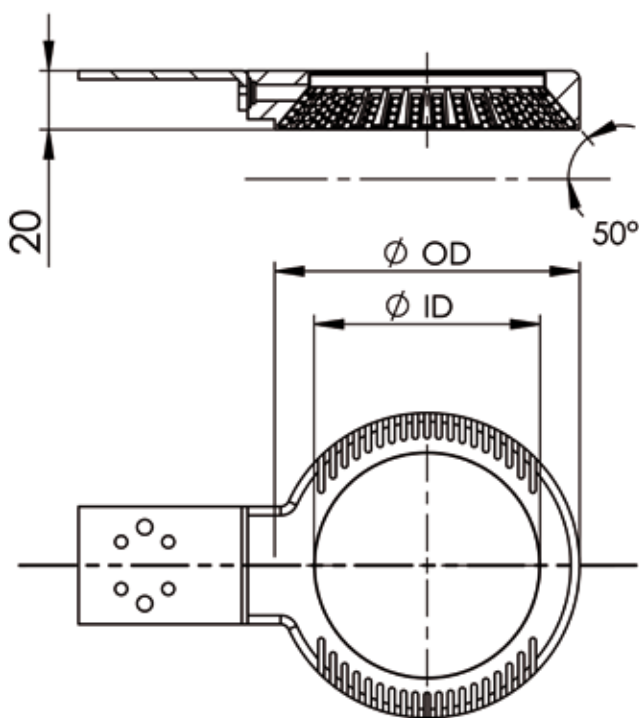

Order information

Order number	Sizes (mm)		Controller ²⁾	
	outer Ø	inner Ø	steady mode	strobe mode
SAX3 3104	104	76	1 A	8 A
SAX3 3184	184	157	3 A	24 A

²⁾ See controller selection for details

Color information

Replace "X" in order number by one character ¹⁾	Color	Wavelength
H	Red	617 nm
W	White	

¹⁾ Example for red ring light: SAH3 3104

Options

- Cable length and type see "Order options"

Distribution in the UK & Ireland



**Characterisation,
Measurement &
Analysis**

Lambda Photometrics Limited
Lambda House Batford Mill
Harpenden Herts AL5 5BZ
United Kingdom

E: info@lambdaphoto.co.uk
W: www.lambdaphoto.co.uk
T: +44 (0)1582 764334
F: +44 (0)1582 712084