

# KL Accessories

## Accessories for KL Light Sources



SCHOTT offers a variety of mechanical and optical accessories to increase the flexibility of its KL Light Sources. They include color filters, mounting brackets and electrical accessories such as a footswitch.

### Features:

- Daylight and halogen filters available.
- Color filters available in red, blue, green and yellow.
- Mounting brackets for column Ø from 20 – 35 mm.
- Power cords strictly according to international standards.
- Footswitch for remote operations.

### Advantages:

- Compatible with a wide variety of OEM designs.
- Color filters with high transmission and unaffected by light-entrance angle.
- Additional contrast available with a range of filters.
- Mechanically designed for easy handling.

| Accessories                 | Compatible Products                       | Characteristics                                      | Part No. |
|-----------------------------|---|--|----------|
| Base                        | KL 300 LED                                |  | 158.340  |
| Mounting Bracket for Base   | KL 300 LED                                |  | 120.250  |
| Mounting Bracket for Column |   | For Column Ø 20 mm (0.78")                           | 120.220  |
|                             |   | For Column Ø 25 mm (0.98")                           | 120.225  |
|                             |   | For Column Ø 29 mm (1.14")                           | 120.229  |
|                             |   | For Column Ø 32 mm (1.26")                           | 120.232  |
|                             |   | For Column Ø 35 mm (1.38")                           | 120.235  |
|                             |   | For ZEISS stand K, Stand M                           | 120.240  |
| Light Guide Adapter         | KL 1600 LED<br>KL 2500 LED                | For Megalight by SCHOTT Nippon K.K.                  | 158.321  |
|                             |   | For ColdVision by SCHOTT North America               | 158.322  |
|                             |   | For Volpi and Photonic                               | 158.323  |
|                             | KL 1500 HAL                               | For Volpi and Photonic                               | 158.320  |
| Filter Holder               | KL 1500 HAL<br>KL 1600 LED<br>KL 2500 LED | Empty holder for insert filter<br>Ø 28 mm (1.10")    | 258.330  |
| Insert filter Ø 28 mm       | KL 1500 HAL<br>KL 1600 LED<br>KL 2500 LED | Blue   | 258.302  |
|                             |   | Red  | 258.303  |
|                             |   | Green  | 258.304  |
|                             |   | Yellow   | 258.305  |
|                             | KL 1500 HAL                               | Daylight   | 258.306  |
|                             | KL 1600 LED<br>KL 2500 LED                | Halogen  | 258.307  |
|                             | KL 2500 LED                               | For fluorescence excitation blue $\lambda = 450$ nm  | 258.313  |
|                             |   | For fluorescence excitation green $\lambda = 540$ nm | 258.314  |
| Power cord 1.8 m            | KL 1500 HAL<br>KL 1600 LED<br>KL 2500 LED | EU Plug: IEC-C13 to CEE 7/7                          | 400.051  |
|                             |   | US Plug: IEC-C13 to NEMA 5-15                        | 400.052  |
|                             |   | UK Plug: IEC-C13 to BS 1363                          | 400.053  |
|                             |   | Swiss Plug: IEC-C13 to SEV1011                       | 400.054  |
| Footswitch                  | KL 2500 LED                               | Momentary  | 400.020  |

Distribution in the UK & Ireland



**Characterisation,  
Measurement &  
Analysis**

**Lambda Photometrics Limited**

Lambda House Batford Mill  
Harpenden Herts AL5 5BZ  
United Kingdom

**E:** [info@lambdaphoto.co.uk](mailto:info@lambdaphoto.co.uk)

**W:** [www.lambdaphoto.co.uk](http://www.lambdaphoto.co.uk)

**T:** +44 (0)1582 764334

**F:** +44 (0)1582 712084

**SCHOTT**  
glass made of ideas

## Mechanical Accessories for KL Light Guides



SCHOTT offers a variety of mechanical accessories to precisely position its KL Light Guides at the required point. Accessories include an articulated arm and base, as well as holders for different size light guides, focusing lenses and adapters for ring lights.

### Features:

- Stable design
- Easy handling
- Adapter for different lens sizes available

### Advantages:

- Precise positioning of light guides
- Compatible with different OEM designs

## Types

| Accessories     | Compatible Products                                  |                                   | Characteristics                                | Part No. |
|-----------------|--|-----------------------------------|--|----------|
| Holder          | For Annular Ring Lights                              |                                   | 1x M6 thread                                   | 157.430  |
|                 | For Flexible Light Guides                            | Ø up to 5.0 mm (0.20")            | 1x M6 thread                                   | 158.330  |
|                 |  | Ø 8.0 mm + 9.0 mm (0.31" + 0.35") | 1x M6 thread                                   | 158.335  |
|                 |  | Ø 12.0 + 15.0 mm (0.47" + 0.59")  | 3x M6 threads                                  | 157.430  |
|                 | For Focusing Lenses                                  | Ø up to 5.0 mm (0.20")            |  | 158.341  |
|                 |  | Ø 8.0 mm (0.31")                  |  | 157.430  |
| Articulated Arm | For Line Lights, Ring Lights & Flexible Light Guides |                                   | 200 mm (7.87") length / 2x M6 threads          | 158.345  |
| Base            | For Articulated Arm                                  |                                   | Ø 100 mm (3.94") / 3x M6 holes                 | 158.340  |
| Adapter         | For Combi Light Guide                                |                                   | For Ø 32 mm (1.26") column                     | 158.402  |
|                 | For Brightfield Ring Lights                          | Ø 66 mm (2.60")                   | ID Ø 50 mm to OD Ø 66 mm (1.97" to 2.60")      | 157.448  |
|                 |  |                                   | ID Ø 58 mm to OD Ø 66 mm (2.28" to 2.60")      | 157.450  |
|                 |  |                                   | ID Ø 60 mm to OD Ø 66 mm (2.36" to 2.60")      | 157.452  |
|                 | For Darkfield Ring Lights                            | Ø 66 mm (2.60")                   | Working distance 30 to 50 mm (1.18" to 1.97")  | 157.569  |
|                 |  |                                   | Working distance 50 to 80 mm (1.97" to 3.15")  | 157.567  |
|                 |  |                                   | Working distance 80 to 110 mm (3.15" to 4.33") | 157.562  |
|                 | For Transmitted Light Stage                          | Ø 84 mm                           | For Base Plate Ø 90 mm (3.54")                 | 157.630  |
|                 |  |                                   | For Base Plate Ø 100 mm (3.94")                | 157.600  |
|                 |  |                                   | For Base Plate Ø 120 mm (4.72")                | 157.610  |
|                 |  |                                   | For Base Plate Ø 180 mm (7.09")                | 157.620  |

Version 03.2020

Distribution in the UK & Ireland



**Characterisation,  
Measurement &  
Analysis**

**Lambda Photometrics Limited**  
 Lambda House Batford Mill  
 Harpenden Herts AL5 5BZ  
 United Kingdom  
**E: [info@lambdaphoto.co.uk](mailto:info@lambdaphoto.co.uk)**  
**W: [www.lambdaphoto.co.uk](http://www.lambdaphoto.co.uk)**  
**T: +44 (0)1582 764334**  
**F: +44 (0)1582 712084**

**SCHOTT**  
 glass made of ideas

## Optical Accessories for KL Light Guides



SCHOTT provides a wide range of optical accessories to increase the flexibility of its products, which includes Transmitted Light Stages for backlight illumination, focusing lenses, as well as a large number of filters.

### Features:

- Focusing lenses can increase light intensity at the spot center by a factor of three.
- Cost-effective transmitted brightfield illumination.
- Additional contrast can be achieved using a variety of filters.

### Advantages:

- Compatible with different OEM designs.
- Polarization filters have the optimal extinction ratio.
- Color filters exhibit high transmission rates and remain unaffected by light entrance angle.

## Types

| Accessories             | Compatible Product                |                                   | Characteristics                                  | Part No. |
|-------------------------|-----------------------------------|-----------------------------------|--|----------|
| Transmitted Light Stage | Flexible Light Guides             | Ø up to 5.0 mm (0.20")            | Ø 84 mm (3.31")                                  | 122.150  |
| Diffuse Face Light      | Flexible Light Guides             | Ø 8.0 mm + 9.0 mm (0.31" + 0.35") | Active area 78 x 30 mm (3.07" x 1.18")           | 500.100  |
| Focusing Lens           | Flexible Light Guides & Gooseneck | Ø up to 5.0 mm (0.20")            |  | 158.210  |
|                         |                                   |                                   | with colour filter set: red, blue, green, yellow | 158.200  |
|                         | Flexible Light Guides             | Ø 8.0 mm + 9.0 mm (0.31" + 0.35") |  | 158.215  |
|                         |                                   |                                   |  |          |
| Analyzer*               | Transmitted Light Stage           | with Polarization Filter          | M 49 x 0.75                                      | 158.505  |
|                         |                                   |                                   | M 52 x 1.0                                       | 158.510  |
| Polarization Filter     | Transmitted Light Stage           |                                   | Ø 84 mm (3.31")                                  | 158.500  |
|                         | Annular Ring Light                |                                   | Ø 66 mm (2.60")                                  | 158.430  |
|                         |                                   |                                   | Ø 58 mm (2.28")                                  | 158.440  |
|                         | Focusing Lens                     | Ø up to 5.0 mm (0.20")            | Twistable  | 158.205  |
|                         |                                   | Ø 8.0 mm + 9.0 mm (0.31" + 0.35") | Twistable  | 158.206  |
| Daylight Filter         | Focusing Lens                     | Ø up to 5.0 mm (0.20")            |  | 158.211  |
| Halogen Filter          |                                   |                                   |  | 158.207  |

\* Analyzer for specific objective types may need to be purchased from the accessory range of the microscope/objective vendor

Distribution in the UK & Ireland



**Characterisation,  
Measurement &  
Analysis**

**Lambda Photometrics Limited**  
 Lambda House Batford Mill  
 Harpenden Herts AL5 5BZ  
 United Kingdom  
 E: [info@lambdaphoto.co.uk](mailto:info@lambdaphoto.co.uk)  
 W: [www.lambdaphoto.co.uk](http://www.lambdaphoto.co.uk)  
 T: +44 (0)1582 764334  
 F: +44 (0)1582 712084



## Dimensions – Accessories for KL Light Sources

### Base

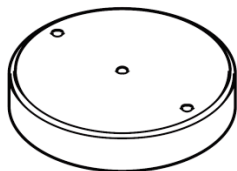

P/N: 158.340

### Mounting bracket for base

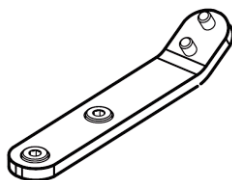

P/N: 120.250

### Mounting bracket for column

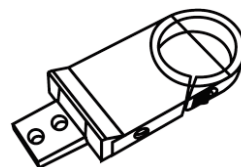

P/N: 120.220 | 120.225 | 120.229 |  
120.232 | 120.235 | 120.240

### Filter Holder

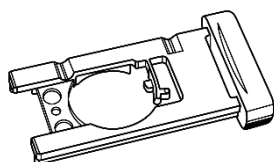

P/N: 258.330

### Insert Filter



P/N: 258.302 | 258.303 | 258.304 |  
258.305 | 258.306 | 258.307 |  
258.313 | 258.314

### Power Cord

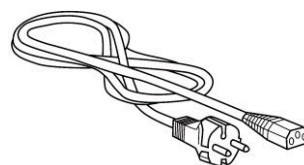

P/N: 400.051 | 400.052 | 400.053 |  
400.054

### Footswitch

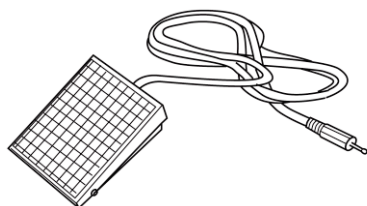

P/N: 400.020

### Light Guide Adapter

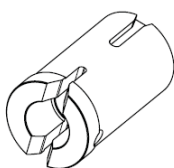

P/N: 158.321 | 158.322 | 158.323 |  
158.320

Pictures are provided for illustration purposes only, and may not provide an accurate reflection of the actual product.

Distribution in the UK & Ireland



**Characterisation,  
Measurement &  
Analysis**

**Lambda Photometrics Limited**  
Lambda House Batford Mill  
Harpenden Herts AL5 5BZ  
United Kingdom  
E: [info@lambdaphoto.co.uk](mailto:info@lambdaphoto.co.uk)  
W: [www.lambdaphoto.co.uk](http://www.lambdaphoto.co.uk)  
T: +44 (0)1582 764334  
F: +44 (0)1582 712084

**SCHOTT**  
glass made of ideas

## Dimensions – Mechanical Accessories for KL Light Guides

### Holder

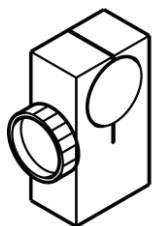

P/N: 157.430

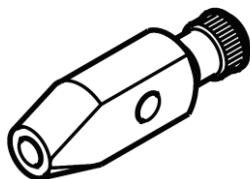

P/N: 158.330 | 158.335

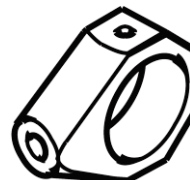

P/N: 158.341

### Articulated arm and base

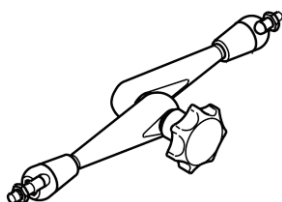

P/N: 158.345

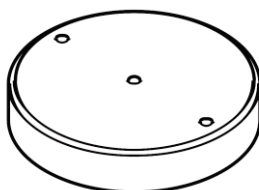

P/N: 158.340

### Adapter

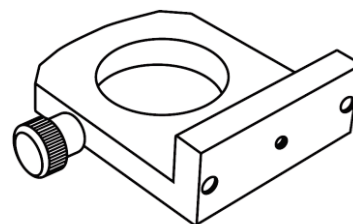

P/N: 158.402

### Adapter

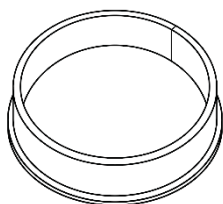

P/N: 157.448 | 157.450 | 157.452

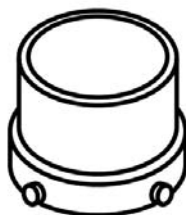

P/N: 157.569 | 157.567 |  
157.562

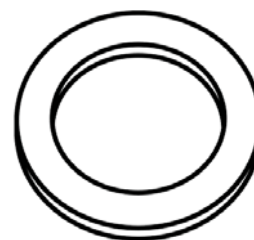

P/N: 157.630 | 157.600 |  
157.610 | 157.620

Pictures are provided for illustration purposes only, and may not provide an accurate reflection of the actual product.

Distribution in the UK & Ireland



**Characterisation,  
Measurement &  
Analysis**

**Lambda Photometrics Limited**  
Lambda House Batford Mill  
Harpenden Herts AL5 5BZ  
United Kingdom  
E: [info@lambdaphoto.co.uk](mailto:info@lambdaphoto.co.uk)  
W: [www.lambdaphoto.co.uk](http://www.lambdaphoto.co.uk)  
T: +44 (0)1582 764334  
F: +44 (0)1582 712084

**SCHOTT**  
glass made of ideas

## Dimensions – Optical Accessories for KL Light Guides

**Transmitted Light Stage**

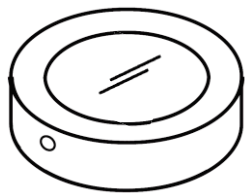

P/N: 157.430

**Diffuse Facelight**

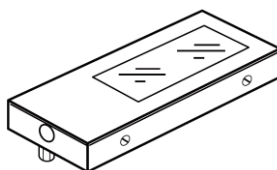

P/N: 500.100

**Focusing Lens**

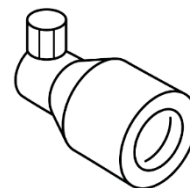

P/N: 158.210 | 158.215

**Focusing Lens with filter Set**

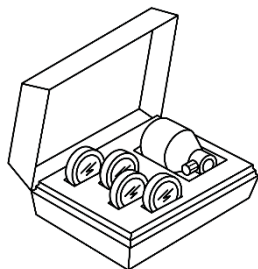

P/N: 158.200

**Daylight & Halogen Filter**



P/N: 158.211 | 158.207

**Analyzer**



P/N: 158.505 | 158.510

**Polarizing filter for Transmitted Light Stage**

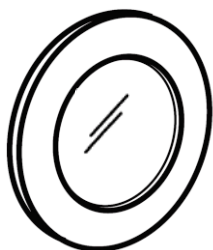

P/N: 158.500

**Polarizing filter for Annular Ring Light**

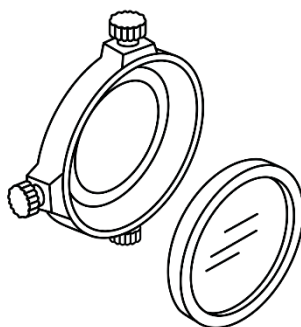

P/N: 158.430 | 158.440

**Polarization Filter for Focusing Lens**



P/N: 158.205 | 158.206

Pictures are provided for illustration purposes only, and may not provide an accurate reflection of the actual product.

Distribution in the UK & Ireland



**Lambda Photometrics Limited**  
 Lambda House Batford Mill  
 Harpenden Herts AL5 5BZ  
 United Kingdom  
 E: [info@lambdaphoto.co.uk](mailto:info@lambdaphoto.co.uk)  
 W: [www.lambdaphoto.co.uk](http://www.lambdaphoto.co.uk)  
 T: +44 (0)1582 764334  
 F: +44 (0)1582 712084

All specifications are subject to change without prior notice. This datasheet or any extracts thereof may only be used in other publications with express permission of SCHOTT. © SCHOTT AG

**SCHOTT**  
 glass made of ideas