

KL Flexible Light Guides

for KL Light Sources



SCHOTT Flexible Light Guides are highly bendable. In contrast to goosenecks, they allow a higher flexibility and need to be held.

Features:

- Flexible Light Guides are available in different lengths and diameters.
- Available with one, two or three branches
- Focusing optics, filters and mechanical accessories available.
- High white light transmission thanks to the use of SCHOTT PURAVIS® fibers.

Advantages:

- High flexibility for different lighting, as well as remote illumination.

Types and compatibility

Type	Compatible cold light source	Part No.	Length	End tip Ø	End tip length	Active Ø branch	Active Common end Ø	Outer Ø Jacketing	Light source adapter Ø
			(L)	(E)	(l)	(b)	(B)	(D)	(F)
1-branch	KL 300 LED	121.101	600 mm 23.62"	6 mm 0.24"	20 mm 0.79"	4,5 mm 0.16"	4,5 mm 0.16"	6,5 mm 0.26"	9 mm 0.35"
		171.101	1000 mm 39.37"	6 mm 0.24"	20 mm 0.79"	4,5 mm 0.16"	4,5 mm 0.16"	6,5 mm 0.26"	9 mm 0.35"
	KL 1500 HAL KL 1600 LED KL 2500 LED	155.100	1000 mm 39.37"	6 mm 0.24"	20 mm 0.79"	5.0 mm 0.20"	5.0 mm 0.20"	9.8 mm 0.39"	10 mm 0.39"
		155.102	1600 mm 62.99"	6 mm 0.24"	20 mm 0.79"	5.0 mm 0.20"	5.0 mm 0.20"	9.8 mm 0.39"	10 mm 0.39"
		155.103	1000 mm 39.37"	10 mm 0.39"	20 mm 0.79"	8.0 mm 0.32"	8.0 mm 0.32"	14 mm 0.55"	10 mm 0.39"
		155.104	1000 mm 39.37"	10 mm 0.39"	20 mm 0.79"	9.0 mm 0.35"	9.0 mm 0.35"	14 mm 0.55"	10 mm 0.39"
2-branch	KL 300 LED	171.202	1000 mm 39.37"	6 mm 0.24"	20 mm 0.79"	4,5 mm 0.16"	6,4 mm 0.22"	6,5 mm 0.26"	9 mm 0.35"
	KL 1500 HAL KL 1600 LED KL 2500 LED	155.204	1000 mm 39.37"	6 mm 0.24"	20 mm 0.79"	4.5 mm 0.18"	6.4 mm 0.25 "	9.8 mm 0.39"	10 mm 0.39"
		155.205	1600 mm 62.99"	6 mm 0.24"	20 mm 0.79"	4.5 mm 0.18"	6.4 mm 0.25"	9.8 mm 0.39"	10 mm 0.39"
3-branch	KL 1500 HAL KL 1600 LED KL 2500 LED	155.206	1000 mm 39.37"	6 mm 0.24"	20 mm 0.79"	4.5 mm 0.18"	7.8 mm 0.31"	9.8 mm 0.39"	10 mm 0.39"

For compatibility with discontinued SCHOTT light sources and third party products, please contact us.

We provide a variety of optical and mechanical accessories for our KL light guides. For details please refer to our system diagrams or according datasheets.

Distribution in the UK & Ireland



Lambda Photometrics Limited
 Lambda House Batford Mill
 Harpenden Herts AL5 5BZ
 United Kingdom
E: info@lambdaphoto.co.uk
W: www.lambdaphoto.co.uk
T: +44 (0)1582 764334
F: +44 (0)1582 712084

**Characterisation,
 Measurement &
 Analysis**



Dimensions

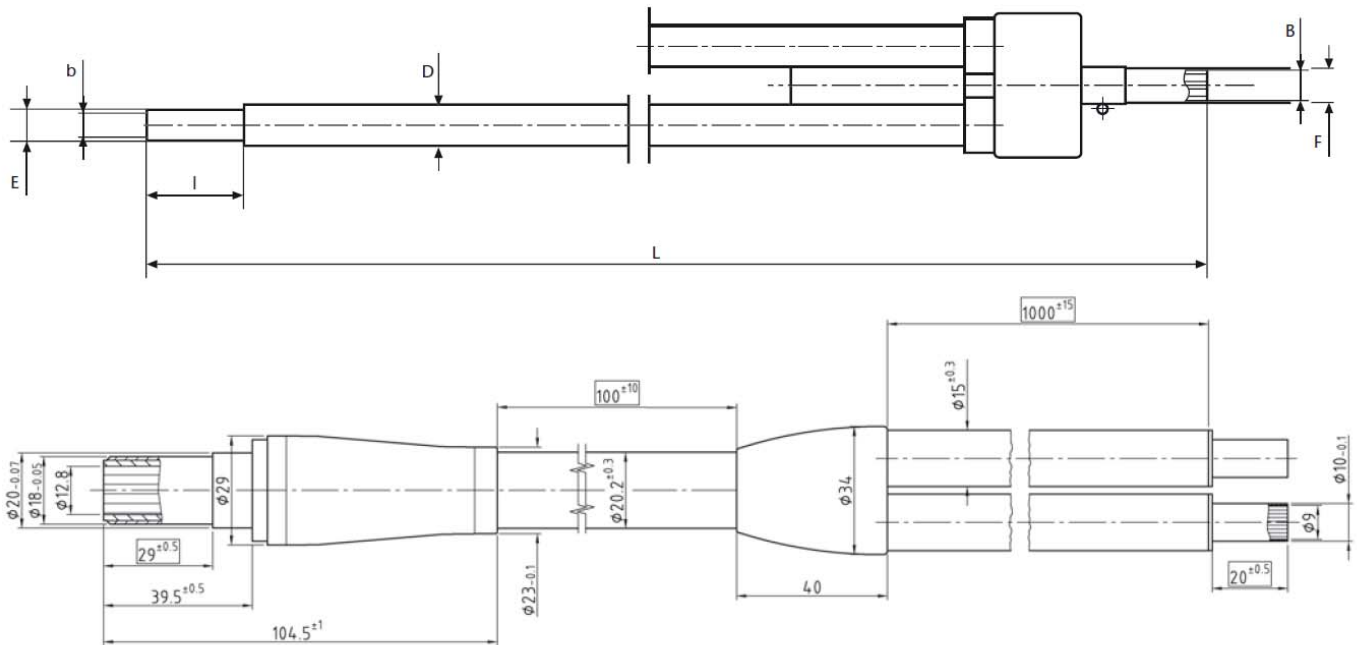

Pictures are provided for illustration purposes only, and may not provide an accurate reflection of the actual product.

All specifications are subject to change without prior notice. This datasheet or any extracts thereof may only be used in other publications with express permission of SCHOTT. © SCHOTT AG

Lighting and Imaging
SCHOTT AG
 Hattenbergstrasse 10
 55122 Mainz
 Germany
 Phone: +49 (0) 6131/66-7796
 Fax: +49 (0) 6131/66-7850
 info.microscopy@schott.com
 www.schott.com/microscopy

SCHOTT
 glass made of ideas