

# SLM 355

Single longitudinal mode  
TEM<sub>00</sub> beam profile  
Q-switched solid-state laser  
Wavelength 355 nm

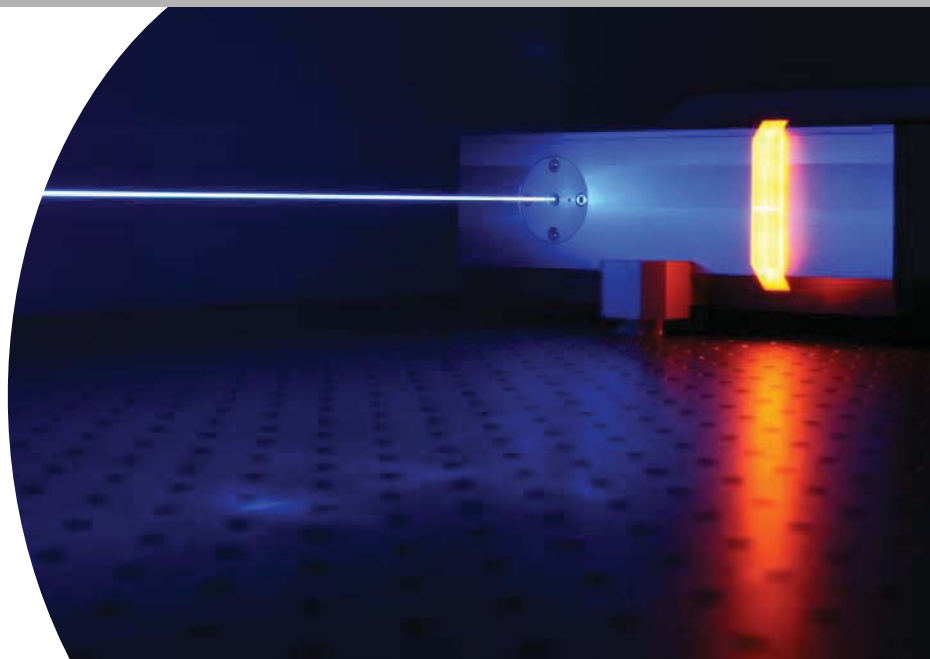

## General description

The SLM 355 is a single-frequency all-solid-state laser system for applications in the UV such as optical metrology, calibration of spectrometers and holographic applications. The spectral bandwidth of less than 60 MHz is near its theoretical Fourier limit.

The laser provides short output pulses with a duration of 10 - 12 ns in a diffraction-limited beam with  $M^2 < 1.3$  at repetition rates between 1 and 15 kHz. The average output power is more than 2 W at 355 nm with ultra-stable pulse traces and a high coherence length of more than 2.5 m not presentable with conventional lasers.

Due to a cw single-frequency seed the consecutive laser pulses remain in phase to allow stable interference patterns, e.g. for exposing directly lithographic films. In addition the 2 W average output power promise short exposure times for a high throughput.

This combination out of short 355 nm wavelength, 2 W average output power and single frequency emission is a unique feature combination for a solid state laser.

## Product specifications

<b>Model</b>	<b>SLM 355</b>
<b>Wavelength</b>	355 nm
<b>Average power</b>	2 W
<b>Pulse duration (typ)</b>	10-12 ns
<b>Energy per pulse</b>	200 µJ
<b>Repetition rate</b>	1-15 kHz
<b>M<sup>2</sup></b>	< 1.3
<b>Spectral bandwidth</b>	< 60 MHz
<b>Coherence length</b>	> 2.5 m

\* Data at 10 kHz pulse repetition rate.  
Specifications are subject to change  
without notice due to product improvement.

## Applications

Interferometry  
Raman spectroscopy  
Holography  
Spectrometer calibration  
Metrology  
Lithography

## Optional

Graphical user interface  
LabVIEW libraries  
CDRH compliance shutter

## Typical performance

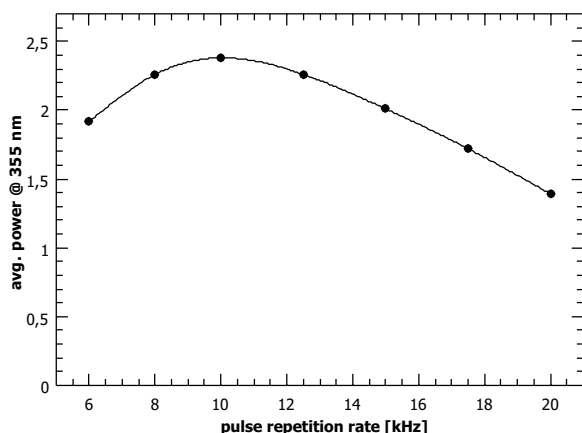

## Typical beam profile

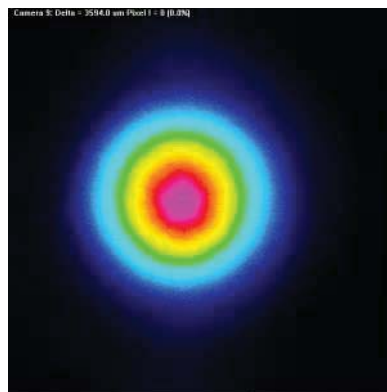

## Dimensions laser head

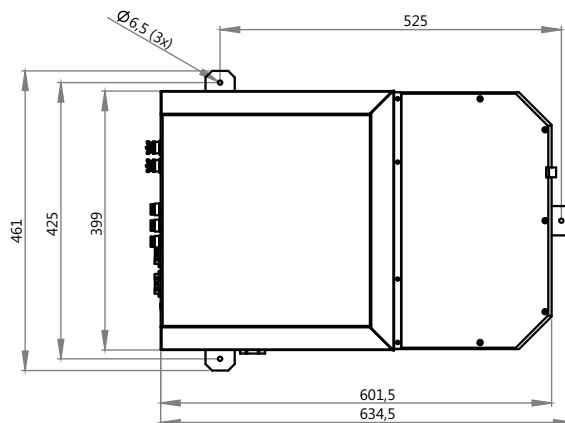
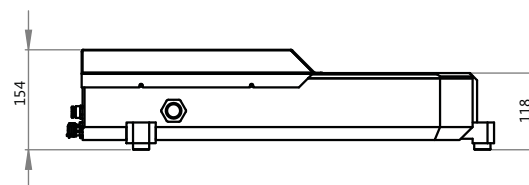
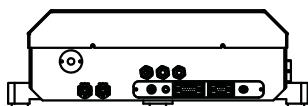
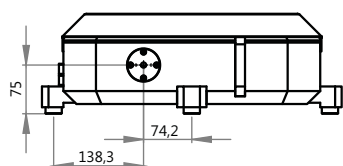

## System dimensions (L x W x H), weight

<b>Laser head</b>	635 x 461 x 154 mm <sup>3</sup>	46 kg
<b>Power supply (including chiller)</b>	600 x 600 x 600 mm <sup>3</sup>	78 kg

## Electrical characteristics

<b>Operating voltage</b>	85-264 VAC
<b>Frequency</b>	47-63 Hz
<b>Power consumption</b>	650 W typ

Distribution in the UK & Ireland



**Characterisation,  
Measurement &  
Analysis**

**Lambda Photometrics Limited**  
Lambda House Batford Mill  
Harpenden Herts AL5 5BZ  
United Kingdom  
E: [info@lambdaphoto.co.uk](mailto:info@lambdaphoto.co.uk)  
W: [www.lambdaphoto.co.uk](http://www.lambdaphoto.co.uk)  
T: +44 (0)1582 764334  
F: +44 (0)1582 712084

